

Axessline outlet

935-T2DC

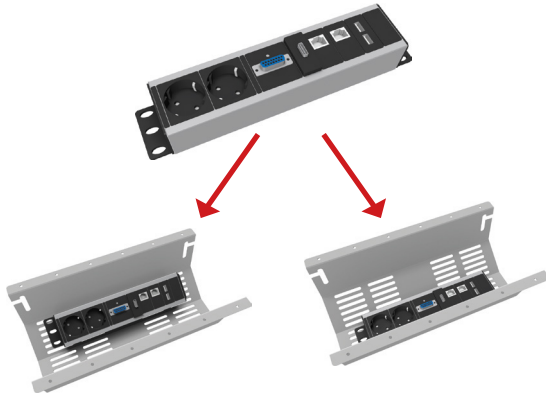

- 1a** ASSEMBLE
Position the outlet to desired position. Align the holes and fixate using screws.



- 1b** ASSEMBLE
Fixate outlet to bracket, and mount the bracket to the table using wood screws.

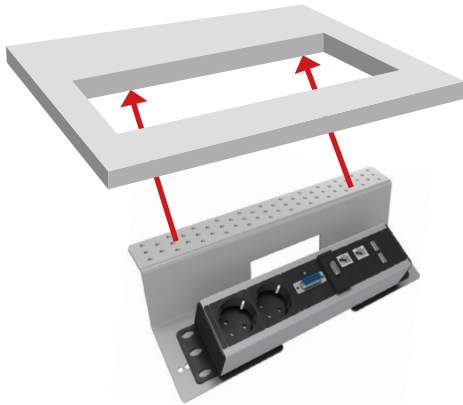

- 2** CONNECT
Connect cables to corresponding external components.

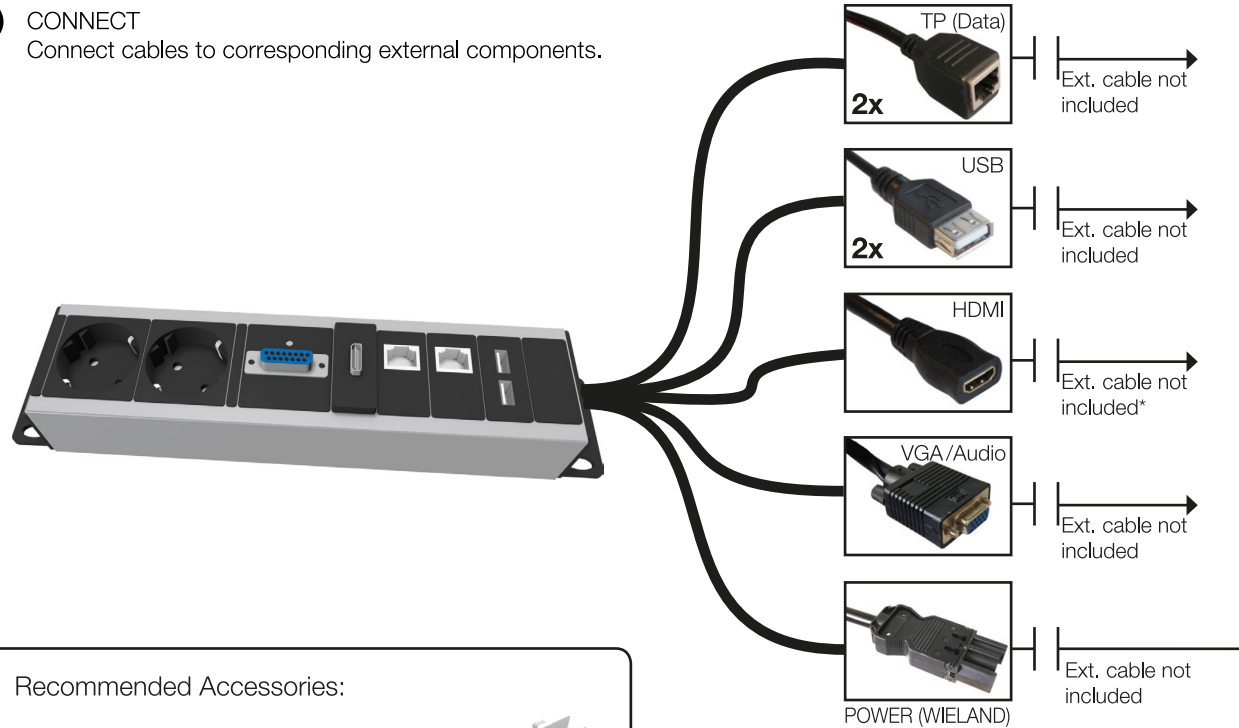

Recommended Accessories:

429-FX01 Cable Tray Expand



935-TK28 Mounting Bracket



935-TK31 Axessline PDU Tray



*Considerations for HDMI usage: One should not exceed a length of 8-10 meters! In such cases, amplifiers should be used! Factors that affect the signal include cable quality, contacts, data amount (resolution) and source strength.

Accessories:
Wieland ↔ Schuko
2.0 m **935-BA20**
3.0 m **935-BA30**
5.0 m **935-BA50**



WIELAND GST1813S Female type
Part no 92.931.3053.1
VDE Approval no. 40018414

Cable cord specification
H05VV-F according to EN 50525-2-11
minimum 3 x 1.5 mm